



Installation Instructions

sales@premiumlighting.com.au | +61 8 9248 1888

premiumlighting.com.au

Cuadro Step Light			
		IP65	   
24VDC Class III	Power: 2 Watt	Material: Aluminium	Warranty: 3 Years

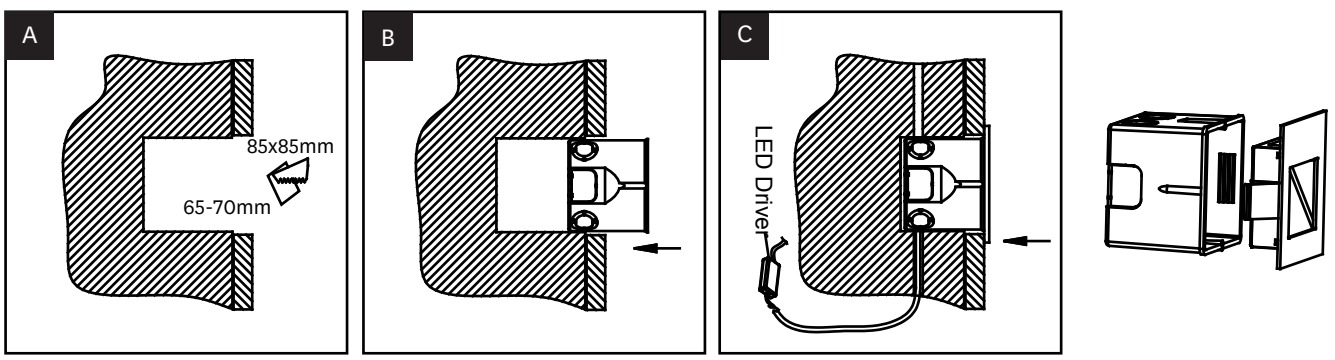

Note: For installation without canister, cut a hole size of L77 x W77 x D25mm.

Installation Instructions

- 01 Must be installed by an Australian Licensed Electrician.
- 02 Before installing, make sure the power supply is switched off.
- 03 Follow the steps in the above figure for installation.
A. After holing, pull out the wires.
B. Fix the canister into the wall (if applicable).
C. Connect the wires in parallel.
D. Check luminaires have been wired in the correct order as per diagram.
- 04 After completing every step, tighten the screws, have the fixture fixed and then connect the power supply. *Note: Termination of wiring and installation of the product shall be conducted such that the luminaire's stated IP rating is not affected.*

Cleaning

- 01 Before cleaning, ensure that the power supply is switched off.
- 02 Use only a soft cloth clean the luminaire, dampened with a mild cleanser if needed for resistant dirt.
- 03 Warning: Do not use alcohol or other solvents.

Wiring

Note: Luminaires are to be wired in Parallel. If dimming, a dimmable driver must be used. Please refer to driver instructions for pairing of suitable dimming system.

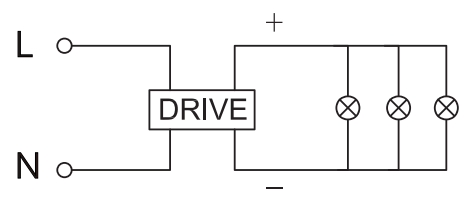

CAUTION: MUST BE INSTALLED BY A LICENSED ELECTRICIAN

FOR WARRANTY INFORMATION VISIT WWW.PREMIUMLIGHTING.COM.AU/WARRANTY

PLEASE READ THESE INSTALLATION INSTRUCTIONS CAREFULLY BEFORE INSTALLING THIS LUMINAIRE. THE LUMINAIRE IS DESIGNED FOR INSTALLATION IN ACCORDANCE WITH RELEVANT AUSTRALIAN STANDARDS (AS/NZS 3000). IF LUMINAIRE IS NOT INSTALLED ACCORDING TO THE INSTRUCTIONS ABOVE, THE WARRANTY FOR THE LUMINAIRE MAY BE VOID.